

REMOVED ROW

PLAN SHOWING THE PROPOSED RESIDENCE IN PLOT NO 16, S.NO. 155A OF NEMILICHERY VILLAGE, SAIDAPET TALUK,

SCALE 1" TO 80" (1:800)

**SCHEDULE OF JOINERY**

D	C.W. FRAMED & PANELLED DOOR	3'-0" X 7'-0"	915 X 2100
D1	- DO -	2'-6" X 6'-6"	750 X 1980
W	C.W. FRAMED & GLAZED WINDOW WITH GRILLE	3'-0" X 4'-0"	915 X 1220
W2	DO	2'-0" X 4'-0"	915 X 1220
W1	- DO -	4'-6" X 4'-0"	1370 X 1220
V	GLAZED VENTILATOR	3'-0" X 1'-6"	610 X 450
V1	DO	3'-0" X 1'-6"	610 X 450

**SPECIFICATIONS**

PCC 1:5:10 IN FOUNDATION OVER 9"TK. SAND FILLING. RR MASONRY IN FOUNDATION IN CM 1:6 UP TO BASEMENT. BRICK WORK IN CM 1:5 IN SUPER-STRUCTURE AND PLASTERING IN CM 1:5 - 3/4"TK. ROOF IN RCC 1:2:4 WITH WEATHERING COURSE ON TOP LAID TO SLOPE. LINCELS, SUNSHADES, SHELVES SLABS & LOFTS IN RCC 1:2:4. FLOOR FINISH IN MOSAIC TILES OF 1/2"TK. OVER PCC 1:5:10 - 4"TK. JOINERY IN WOOD SEA SONED WOOD WORK

PLOT AREA	2400 SQM	224 SQM
PLINTH AREA	842	78
MAIN BUILDING	145	14
PORCH		

PROPOSED WORK SHOWN AS:  
 EXISTING ROAD  
 BOUNDARY LINE  
 DRAINAGE LINE

SIGNATURE OF THE OWNER

*R. Mohan Rao*  
 R. Mohan Rao, D.O.S  
 LICENSED SURVEYOR  
 Corporation of Madras  
 REG. No: 14  
 AMBATTUR TOWN SHIP  
 ALANDUR MUNICIPALITY  
 Consulting Engineer & Contractor  
 Office: 45, Madhav Road  
 T. Nagar, Madras-600 008

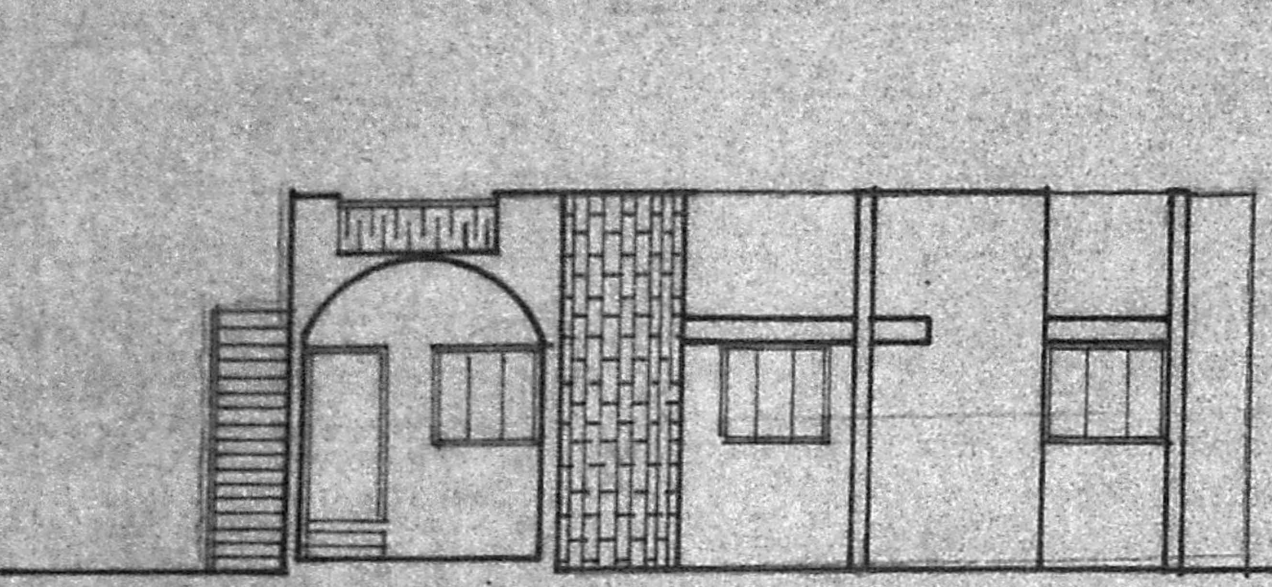

FRONT ELEVATION

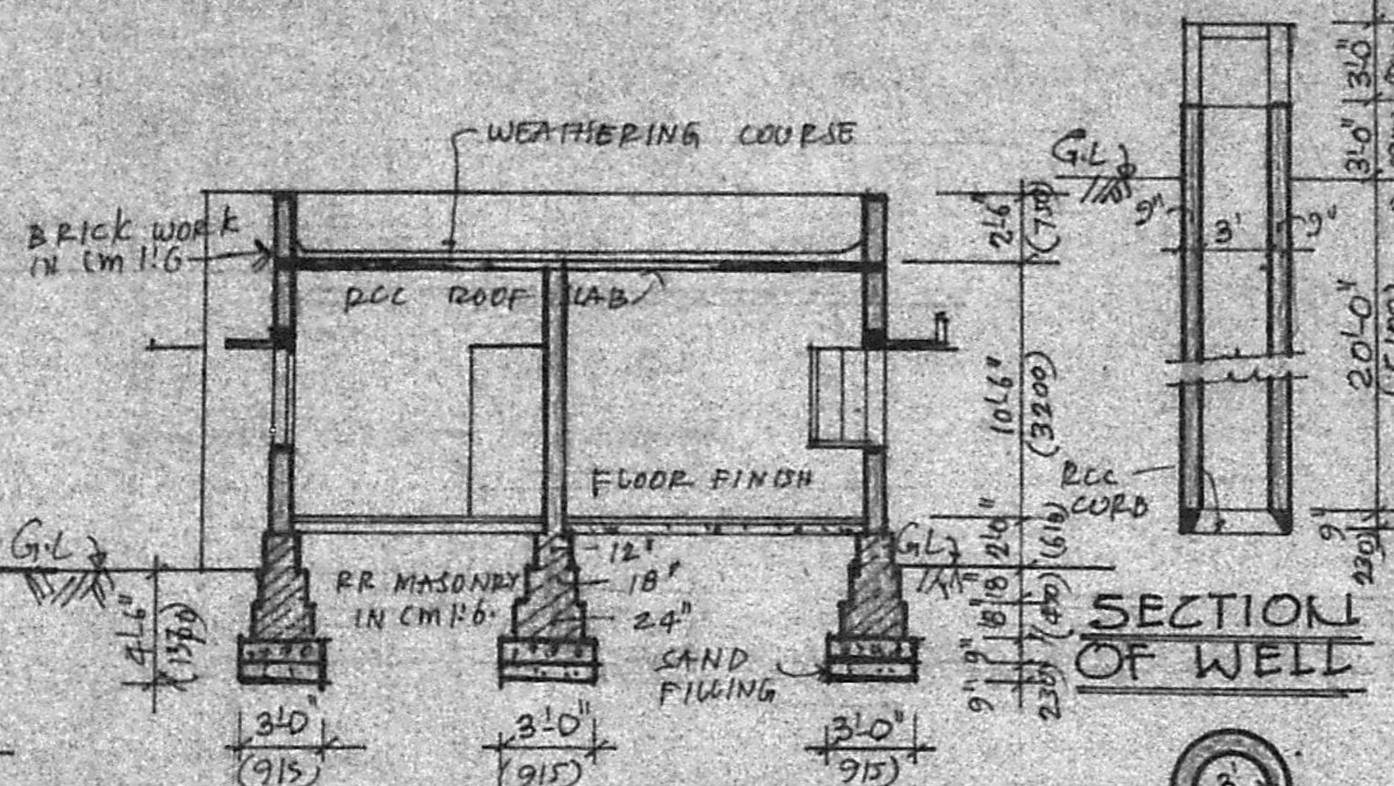

SECTION A-B

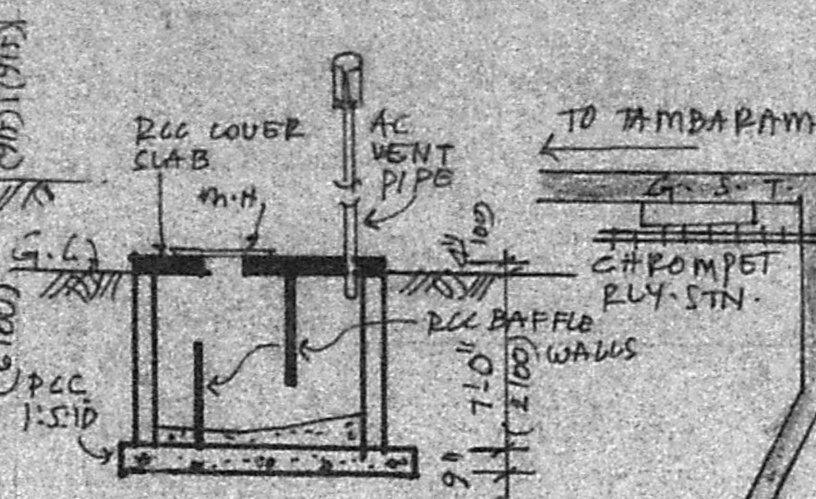

SECTION OF SEPTIC TANK

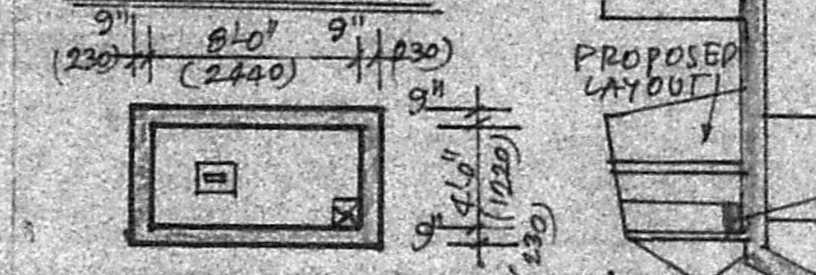

PLAN OF SEPTIC TANK

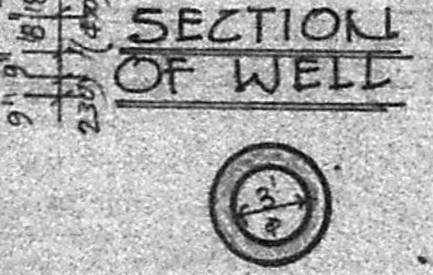

PLAN OF WELL

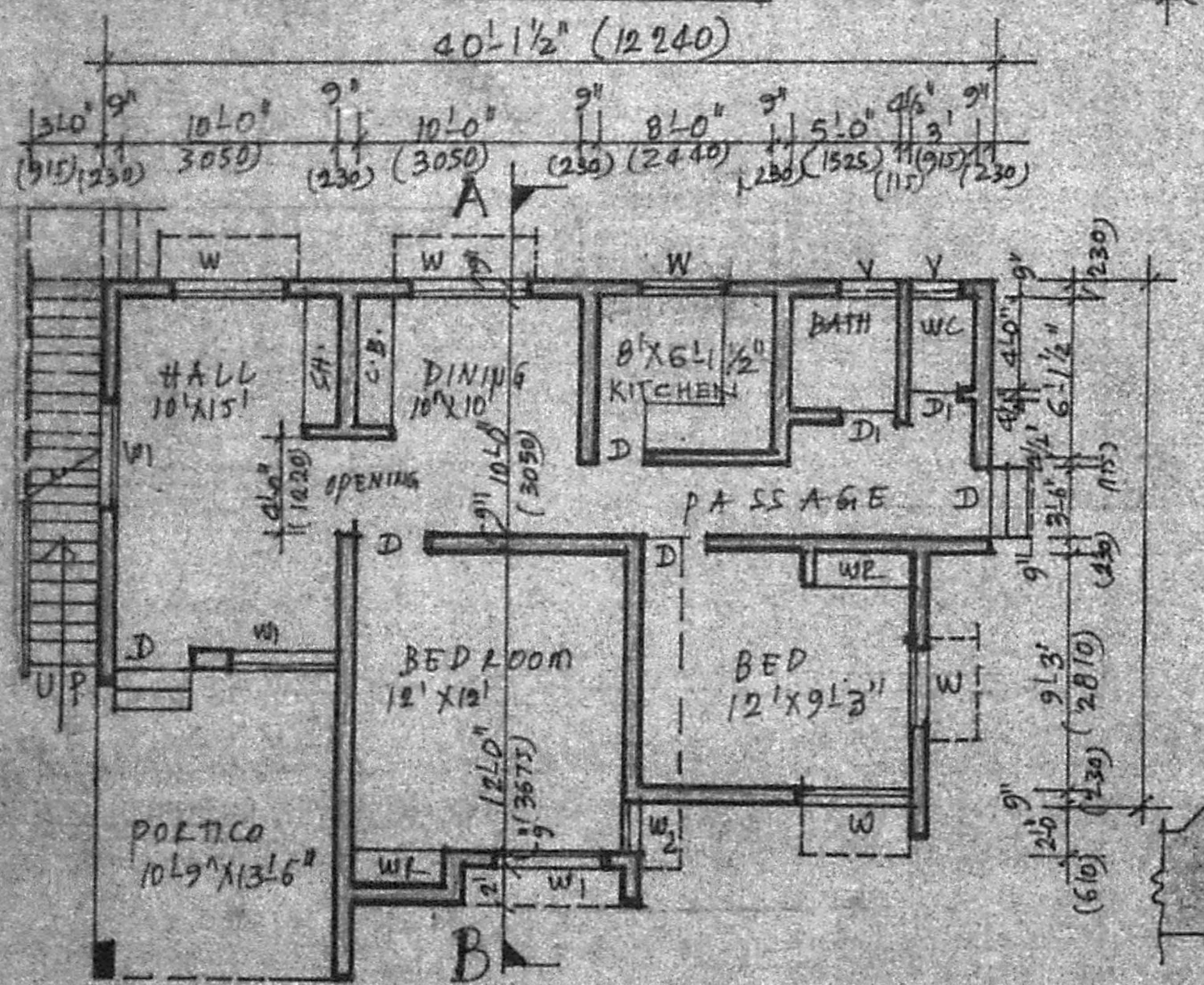

GROUND FLOOR PLAN

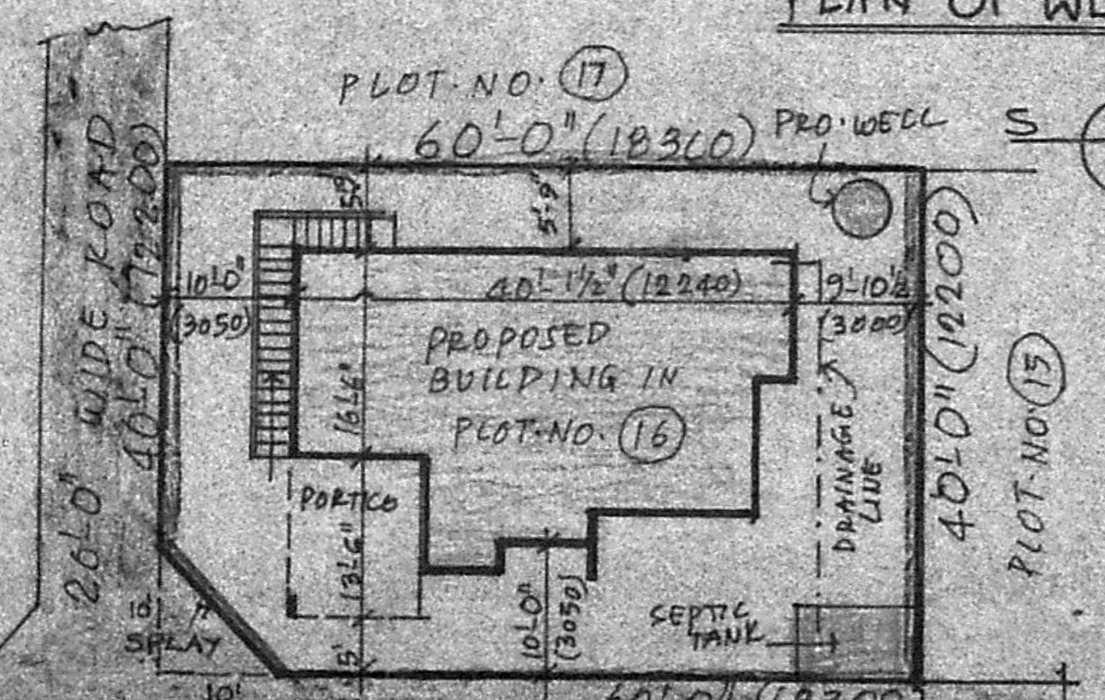

SITE PLAN

APPROVED  
 SUBJECT TO THE CONDITIONS IN THIS OFFICE SETTER  
 No. A2/6650/91/20/2/91  
 FOR MCHS - 3678  
 MADRAS METROPOLITAN DEVELOPMENT AUTHORITY  
 MADRAS 600 008

STAIRCASE  
 WIDTH OF STEP - 30" (915)  
 TREAD OF STEP - 10" (250)  
 RISER - 7" (165)

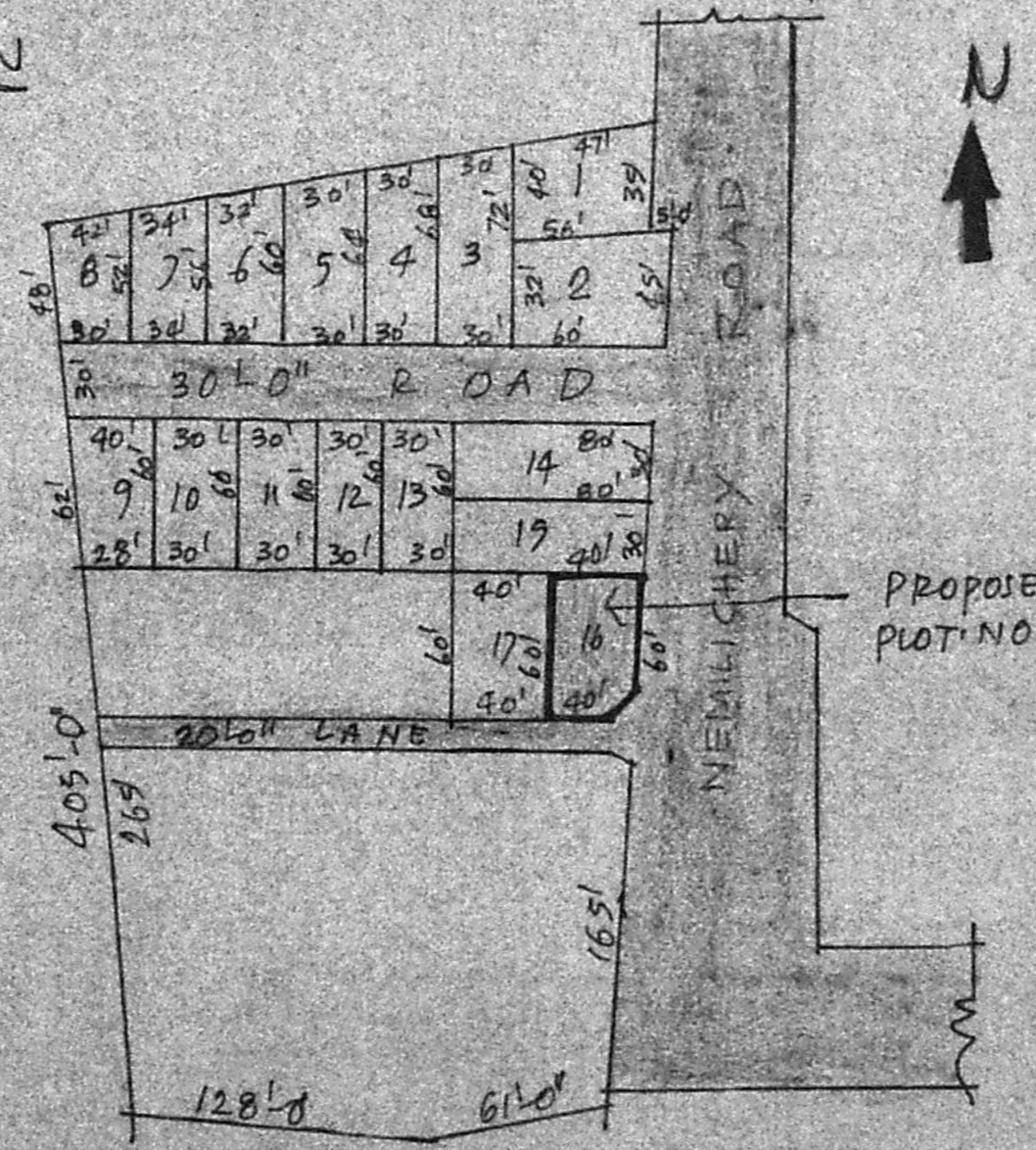

LAYOUT PLAN

LICENCE